



## 插头·插座的插拔强度提高

# 2倍 (原产品比)

带套筒罩已标准化。其中，锁环变更为耐冲击PBT，故耐冲击性提高。

采用独特的连接固定方法  
结构上不使用钢球，故流路不狭窄，虽主体细长，但有效截面积大。

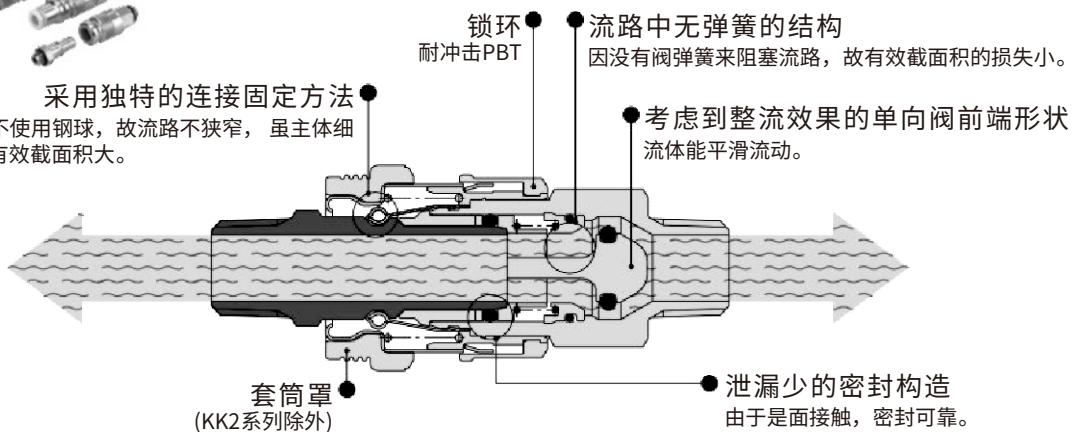

### 质量轻

主体小型化的同时，又采用了冲压件及树脂件，彻底实现了轻量化。

系列	插头型号	插座型号	有效截面积mm <sup>2</sup> <sup>[注1]</sup>	主体外径mm	质量g <sup>[注2]</sup>
RE-KK2系列	RE-KK2P-M5M	KK2S-M5M	3.8	ø10.0	6.1
RE-KK3系列	RE-KK3P-01MS	KK3S-01MS	20	ø20.2	20.1
RE-KK4系列	RE-KK4P-02MS	KK4S-02MS	39	ø28.0	44.1
RE-KK6系列	RE-KK6P-04MS	KK6S-04MS	82	ø31.6	90.1

注1)插头、插座连接时的值。

注2)仅插座的值

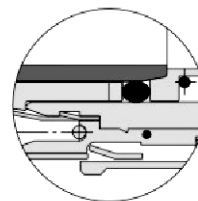

### 带快换接头式已标准化。

4种形式、ø3.2~ø16已系列化。



### 从插头侧或插座侧都可流动。

使用流体：空气、水。

快速连接。

用一只手操作，连接简单，作业性能提高。

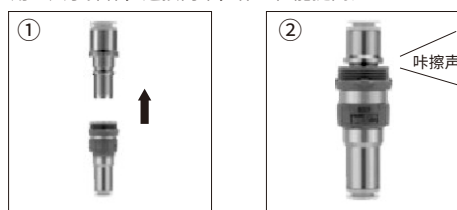

### 套筒锁机构。

防止意外脱离。(注)除M5(KK2系列)外。



**插头(P)**
**外螺纹式**

主体尺寸	接管口径	型号
M5	M5×0.8	RE-KK2P-M5M
	R1/8	-01MS
	R1/8	RE-KK3P-01MS
1/8	R1/4	-02MS
	R3/8	-03MS
	R1/8	RE-KK4P-01M
1/4	R1/4	-01MS
	R3/8	-02MS
	R1/2	-03MS
1/2	R3/8	RE-KK6P-03MS
	R1/2	-04MS
	R3/4	-06MS

**内螺纹式**

主体尺寸	接管口径	型号
M5	M5×0.8	RE-KK2P-M5F
1/8	Rc1/8	RE-KK3P-01F
	Rc1/4	-02F
	Rc3/8	-03F
1/4	Rc1/4	RE-KK4P-02F
	Rc3/8	-03F
	Rc3/8	RE-KK6P-03F
1/2	Rc1/2	-04F

**带螺母管接头式(夹布聚氨酯软管用)**

主体尺寸	接管口径 内径/mm	型号
1/8	5/8	RE-KK3P-50N
	6/9	-60N
	6.5/10	-65N
1/4	5/8	RE-KK4P-50N
	6/9	-60N
	6.5/10	-65N
1/2	8/12	-80N
	8.5/12.5	-85N
	8/12	RE-KK6P-80N
	8.5/12.5	-85N
	11/16	-110N

**快换管接头直通型**

主体尺寸	适合软管外径/mm	型号
M5	3.2	RE-KK2P-23H
	4	-04H
	6	-06H
1/8	4	RE-KK3P-04H
	6	-06H
	8	-08H
1/4	10	-10H
	6	RE-KK4P-06H
	8	-08H
1/2	10	-10H
	12	-12H
	12	RE-KK6P-12H
1/2	16	-16H

**快换管接头弯头型**

主体尺寸	适合软管外径/mm	型号
M5	3.2	RE-KK2P-23L
	4	-04L
	6	-06L
1/8	4	RE-KK3P-04L
	6	-06L
	8	-08L
1/4	10	-10L
	6	RE-KK4P-06L
	8	-08L
1/2	10	-10L
	12	-12L
	12	RE-KK6P-12L
1/2	16	-16L

**快换管接头面板安装型**

主体尺寸	适合软管外径/mm	型号
M5	3.2	RE-KK2P-23E
	4	-04E
	6	-06E
1/8	4	RE-KK3P-04E
	6	-06E
	8	-08E
1/4	10	-10E
	6	RE-KK4P-06E
	8	-08E
1/2	10	-10E
	12	-12E
	12	RE-KK6P-12E
1/2	16	-16E

**插座(S)**
**外螺纹式**

主体尺寸	接管口径	型号
M5	M5×0.8	RE-KK2S-M5M
	R1/8	-01MS
	R1/8	RE-KK3S-01MS
1/8	R1/4	-02MS
	R3/8	-03MS
	R1/8	RE-KK4S-01M
1/4	R1/4	-01MS
	R3/8	-02MS
	R1/2	-03MS
1/2	R3/8	RE-KK6S-03MS
	R1/2	-04MS
	R3/4	-06MS

**内螺纹式**

主体尺寸	接管口径	型号
M5	M5×0.8	RE-KK2S-M5F
1/8	Rc1/8	RE-KK3S-01F
	Rc1/4	-02F
	Rc3/8	-03F
1/4	Rc1/4	RE-KK4S-02F
	Rc3/8	-03F
	Rc3/8	RE-KK6S-03F
1/2	Rc1/2	-04F

**带螺母管接头式(夹布聚氨酯软管用)**

主体尺寸	接管口径 内径/mm	型号
1/8	5/8	RE-KK3S-50N
	6/9	-60N
	6.5/10	-65N
1/4	5/8	RE-KK4S-50N
	6/9	-60N
	6.5/10	-65N
1/2	8/12	-80N
	8.5/12.5	-85N
	8/12	RE-KK6S-80N
	8.5/12.5	-85N
	11/16	-110N

**快换管接头直通型**

主体尺寸	适合软管外径/mm	型号
M5	3.2	RE-KK2S-23H
	4	-04H
	6	-06H
1/8	4	RE-KK3S-04H
	6	-06H
	8	-08H
1/4	10	-10H
	6	RE-KK4S-06H
	8	-08H
1/2	10	-10H
	12	-12H
	12	RE-KK6S-12H
1/2	16	-16H

**快换管接头弯头型**

主体尺寸	适合软管外径/mm	型号
M5	3.2	RE-KK2S-23L
	4	-04L
	6	-06L
1/8	4	RE-KK3S-04L
	6	-06L
	8	-08L
1/4	10	-10L
	6	RE-KK4S-06L
	8	-08L
1/2	10	-10L
	12	-12L
	12	RE-KK6S-12L
1/2	16	-16L

**快换管接头面板安装型**

主体尺寸	适合软管外径/mm	型号
M5	3.2	RE-KK2S-23E
	4	-04E
	6	-06E
1/8	4	RE-KK3S-04E
	6	-06E
	8	-08E
1/4	10	-10E
	6	RE-KK4S-06E
	8	-08E
1/2	10	-10E
	12	-12E
	12	RE-KK6S-12E
1/2	16	-16E

普通型



RE-KK2 系列

RE-KK3、4、6系列

JIS 记号

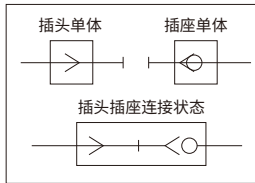

规格

使用流体	空气、水 (一般工业用水)
使用压力范围 <sup>注)</sup>	RE-KK2: -100kPa~1.0MPa RE-KK3: -90kPa~1.0MPa RE-KK4·6: 0~1.0MPa
耐压试验压力	1.5MPa
环境温度及使用流体温度	空气: -5~60°C 水: 5~40°C (但未冻结)
镀层、密封	无电解镀锌 (对应无铜离子)、带外螺纹密封剂

注)因不能保证泄漏为零,故请不要用于泄漏实验、真空保持等场合。

性能

插头·插座连接方法	快速装拆
单向阀	插座:内置单向阀(标准)
套筒锁机构 <sup>注)</sup>	手动锁紧方式(标准)

注)RE-KK2系列无锁紧机构。

有效截面积

主体尺寸	插头	插座	有效截面积 mm <sup>2</sup>
M5	RE-KK2P-M5M	RE-KK2S-M5M	3.8
1/8	RE-KK3P-01MS	RE-KK3S-01MS	20
1/4	RE-KK4P-02MS	RE-KK4S-02MS	39
1/2	RE-KK6P-04MS	RE-KK6S-04MS	82

型号表示方法

RE-KK 4 S — 02 M S

主体尺寸

2	M5
3	1/8
4	1/4
6	1/2

插头·插座区别

S	插座
P	插头

带密封剂(外螺纹)

种类

记号	形式
M	外螺纹
F	内螺纹
N	带螺母管接头式
H	快换接头直通型
L	快换接头弯头型
E	快换接头面板安装型

接管口径扩展品种

外螺纹·内螺纹

记号	接管口径
M5	M5×0.8
01	R, Rc 1/8
02	R, Rc 1/4
03	R, Rc 3/8
04	R, Rc 1/2
06	R, Rc 3/4

快换接头式

记号	适用管子外径 mm
23	φ3.2
04	φ4
06	φ6
08	φ8
10	φ10
12	φ12
16	φ16

带螺母管接头式

记号	适用软管内径/外径 mm
50	5/8
60	6/9
65	6.5/10
80	8/12
85	8.5/12.5
110	11/16

流量特性

空气(0~1MPa)

RE-KK2

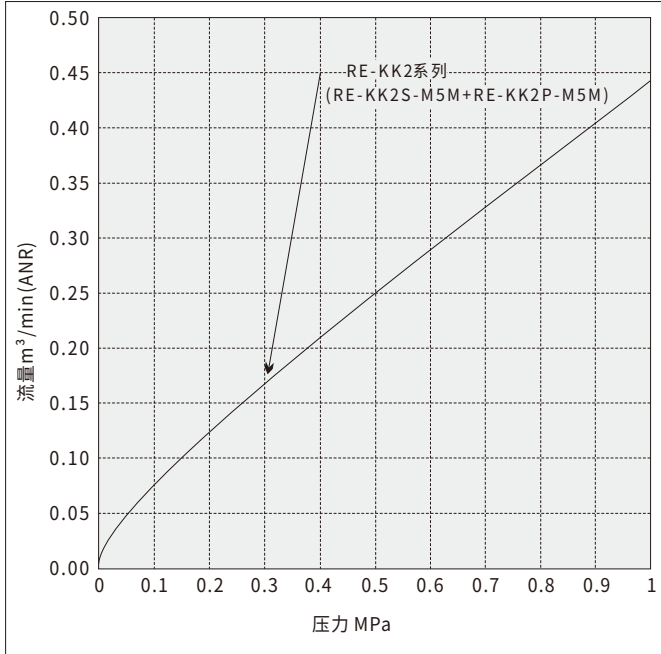

水(0~0.4MPa)

RE-KK2

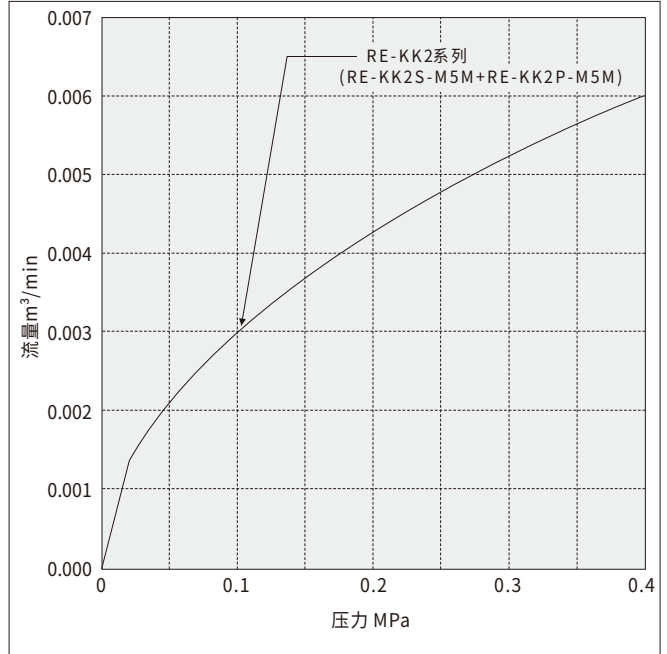

RE-KK3,4,6

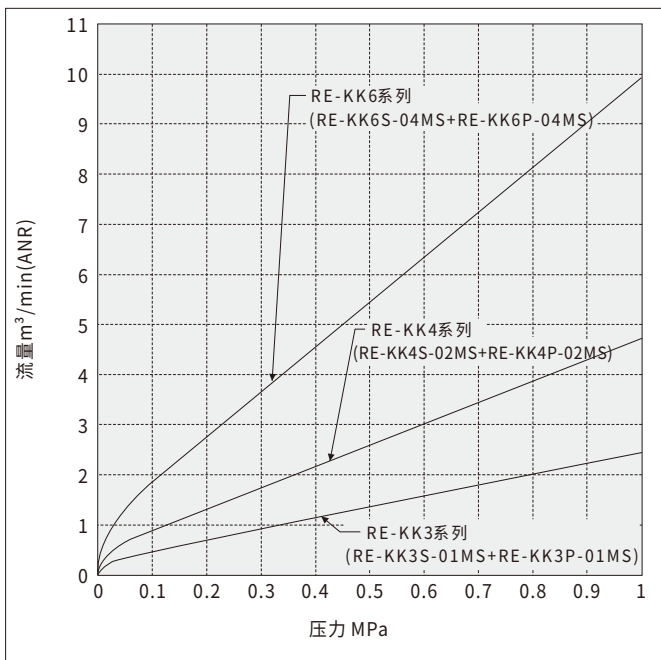

RE-KK3,4,6

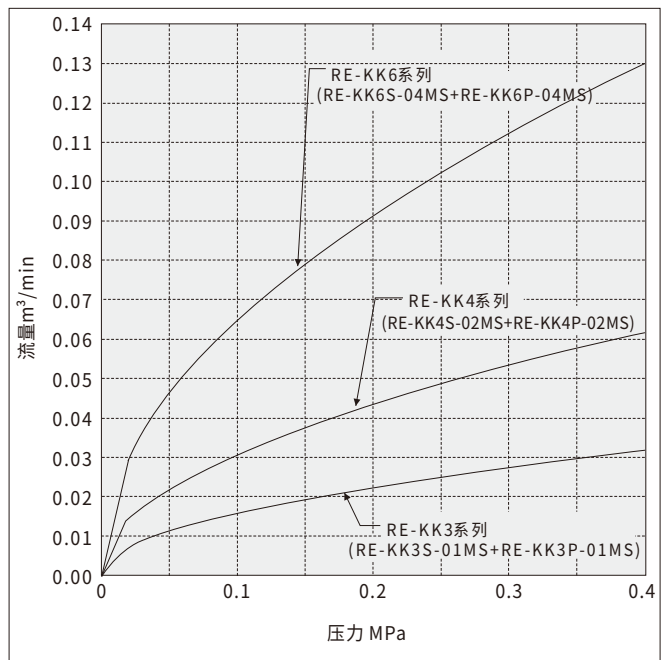

构造图

RE-KK2

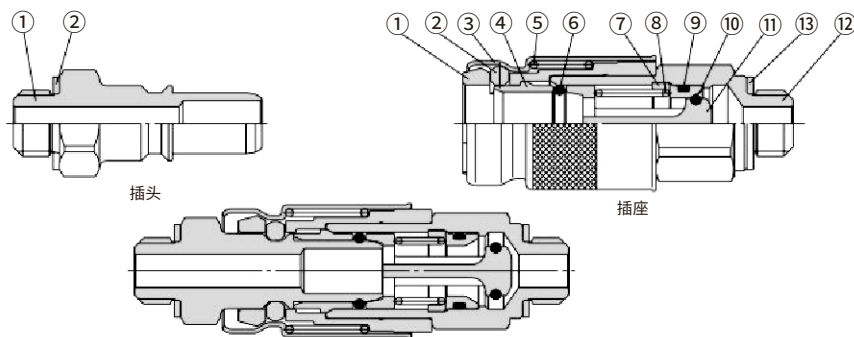

插头

序号	零部件名	材质	备注
1	插头体	黄铜	无电解镀镍
2	垫圈	不锈钢·NBR	

插座

序号	零部件名	材质	备注
1	隔套	PBT	
2	夹头	PBT	
3	套筒	黄铜	无电解镀镍
4	套环	黄铜	无电解镀镍
5	套筒弹簧	不锈钢	
6	插头O形圈	NBR	
7	阀座	PBT	
8	单向阀弹簧	不锈钢	
9	阀座O形圈	NBR	
10	阀芯O形圈	FKM	
11	单向阀	PBT	
12	插座体	黄铜	无电解镀镍
13	垫圈	不锈钢·NBR	

① ② ③ ④ ⑤ ⑥ ⑦ ⑧ ⑨ ⑩ ⑪ ⑬ ⑫

RE-KK3,4,6

<快换接头式的场合>

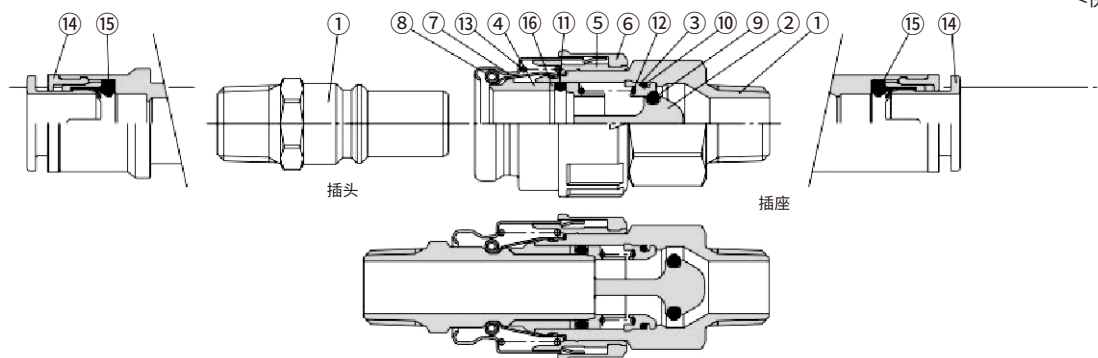

<快换接头式的场合>

插头

序号	零部件名	材质	备注
1	插头主体	黄铜	无电解镀镍
14	压帽	—	
15	密封件	NBR	

插座

序号	零部件名	材质	备注
1	插座主体	黄铜	无电解镀镍
2	阀芯	PBT	
3	阀座	PBT	
4	套环	PBT	
5	隔套	PBT	
6	锁环	耐冲击PBT	
7	套筒	冷轧钢板	无电解镀镍
8	夹头	不锈钢	
9	阀芯O形圈	FKM	
10	阀座O形圈	NBR	
11	插头O形圈	NBR	
12	单向阀弹簧	不锈钢	
13	套筒弹簧	不锈钢	
14	压帽	—	
15	密封圈	NBR	
16	套环2	不锈钢	
17	套筒罩	耐久性NBR	

外形尺寸图/插头(P)

外螺纹式

(mm)

RE-KK2



RE-KK3·4·6



主体尺寸	型号	T 接管口径	H 六角对边	L <sub>1</sub>	L <sub>2</sub>	※A	最小 孔径	有效截面 面积mm <sup>2</sup>	质量 g
M5	RE-KK2P-M5M	M5×0.8	7	18.8	12.3	15.8	2.5	4.4	2.6
	RE-KK2P-01MS	R1/8	10	23.2		19.2	3.4	8.1	3.0
1/8	RE-KK3P-01MS	R1/8	10	30.4	18.4	26.4	6.0	22.6	8.4
	RE-KK3P-05MS	R1/4		33.4		27.4			14.2
	RE-KK3P-03MS	R3/8	17	36.9		30.4			28.1
1/4	RE-KK4P-01MS	R1/8	14	37.0	19.9	33.0	9.0	50.9	17.0
	RE-KK4P-02MS	R1/4		40.2		34.2			20.2
	RE-KK4P-03MS	R3/8	17	42.2		35.7			32.5
1/2	RE-KK4P-04MS	R1/2	22	46.2	25.2	38.2	11.0	76.0	57.4
	RE-KK6P-03MS	R3/8	19	48.0		41.5			44.7
	RE-KK6P-04MS	R1/2	22	52.0		44.0			53.7
	RE-KK6P-06MS	R3/4	27	55.0		45.5			94.4

※R螺纹拧入后的参考尺寸。

RE-KK2

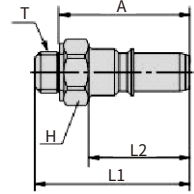

RE-KK3·4·6

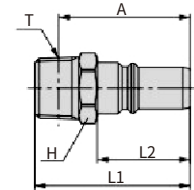

内螺纹式

(mm)



主体尺寸	型号	T 接管口径	H 六角对边	L <sub>1</sub>	L <sub>2</sub>	最小 孔径	有效截面 面积mm <sup>2</sup>	质量 g
M5	RE-KK2P-M5F	M5×0.8	8	17.6	12.3	3.4	8.1	2.6
	RE-KK3P-01F	Rc1/8	14	28.3	18.4	6.0	22.6	10.4
1/8	RE-KK3P-02F	Rc1/4	17	35.0	19.0			20.8
	RE-KK3P-03F	Rc3/8	19	36.8	25.2	9.0	50.9	23.2
1/4	RE-KK4P-02F	Rc1/4	17	37.2				23.9
	RE-KK4P-03F	Rc3/8	19	39.8				24.6
1/2	RE-KK6P-03F	Rc3/8	19	43.3	31.0	13.0	106.2	28.6
	RE-KK6P-04F	Rc1/2	24	50.2				43.9

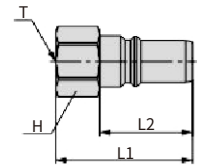

带螺母管接头式(夹布聚氨酯软管用)

(mm)



主体尺寸	型号	适合软管 内径/外径	H1 六角对边	H2 六角对边	L <sub>1</sub>	L <sub>2</sub>	M	最小 孔径	有效截面 面积mm <sup>2</sup>	质量 g	
1/8	RE-KK3P-50N	5/8	14	14	36.1	18.4	13.7	4.5	12.7	21.4	
	RE-KK3P-50N	6/9		17			39.9	16.5	5.4	18.3	38.8
	RE-KK3P-65N	6.5/10		17			39.9	16.5	5.9	21.9	35.9
1/4	REKK4P-50N	5/8	17	14	43.9	25.2	13.7	4.5	12.7	34.7	
	RE-KK4P-60N	6/9					16.5	5.4	18.3	48.4	
	RE-KK4P-65N	6.5/10					16.5	5.9	21.9	45.1	
	RE-KK4P-80N	8/12	17.4	7.4			34.4	53.2			
	RE-KK4P-85N	8.5/12.5	17.4	7.8			38.2	55.6			
	REKK6P-80N	8/12	17.4	7.4			34.4	60.5			
1/2	RE-KK6P-85N	8.5/12.5	19	19	53.4	31.0	17.4	7.8	38.2	62.8	
	RE-KK6P-100N	11/16					24	24	57.2	20.1	10.2

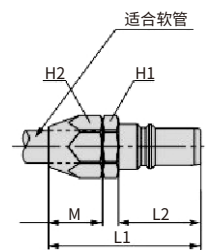

**快换接头直通型**

(mm)

RE-KK2P

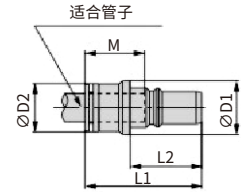

主体尺寸	型号	适合管子外径	øD <sub>1</sub>	øD <sub>2</sub>	L <sub>1</sub>	L <sub>2</sub>	M	最小孔径	有效截面积 mm <sup>2</sup>		质量 g					
									聚氨酯管	尼龙管						
M5	RE-KK2P-23H	ø3.2	10.0	7.0	26.5	12.3				3.7	4.4	3.3				
	RE-KK2P-04H	ø4		8.0									3.4			
	RE-KK2P-06H	ø6		10.0						27	13.5		8.1	4.0		
1/8	RE-KK3P-04H	ø4	12.0	10.0	35.4							7.9				
	RE-KK3P-06H	ø6	14.0	12.0								17.0	4.7	10.1	12.8	9.1
	RE-KK3P-08H	ø8	16.0	14.0								18.5	6.0	15.7	22.6	13.2
	RE-KK3P-10H	ø10	19.0	17.0								21.0		22.6		17.6
1/4	RE-KK4P-06H	ø6	14.0	12.0	46.2	25.2						22.3				
	RE-KK4P-08H	ø8	16.0	14.0								18.5	6.2	19.8	22.6	23.0
	RE-KK3P-10H	ø10	19.0	17.0								21.0	7.7	27.6	35.3	27.1
	RE-KK3P-12H	ø12	21.0	19.0								22.0	9.0	40.2	50.9	30.0
1/2	RE-KK6P-12H	ø16	26.0	25.7	56.1	31.0						44.4				
RE-KK6P-16H	ø16	26.0	25.7	25.0								13.0	—	106.2	50.7	

**快换接头弯头型**

(mm)

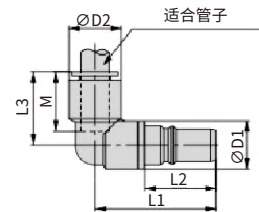

主体尺寸	型号	适合管子外径	øD <sub>1</sub>	øD <sub>2</sub>	L <sub>1</sub>	L <sub>2</sub>	L <sub>3</sub>	M	最小孔径	有效截面积 mm <sup>2</sup>		质量 g							
										聚氨酯管	尼龙管								
M5	RE-KK2P-23L	ø3.2	10.0	9.3	24.0	12.3	16.5	12.7	2.5			5.8							
	RE-KK2P-04L	ø4																	
	RE-KK2P-06L	ø6		11.6									25.1	16.6	13.5	3.4	7.8	7.8	6.4
1/8	RE-KK3P-04L	ø4	12.0	10.4	31.6	18.4						7.2							
	RE-KK3P-06L	ø6		12.8									32.8	20.0	17.0	4.5	10.1	11.4	8.0
	RE-KK3P-08L	ø8		15.2									34.0	23.0	18.5	6.0	15.0	16.8	9.7
	RE-KK3P-10L	ø10		17.0									36.0	26.5	21.0		18.0	18.5	23.0
1/4	RE-KK4P-06L	ø6	14.0	12.8	40.2	25.2						19.6							
	RE-KK4P-08L	ø8	15.2	41.4									23.0	18.5	6.0	17.5	19.8	21.3	
	RE-KK4P-10L	ø12	17.0	44.0									26.5	21.0	7.5	24.7	27.5	25.7	
	RE-KK4P-12L		17.0	44.0									28.5	22.0	9.0	29.0	29.6	28.0	
1/2	RE-KK6P-12L	ø10	19.0	20.9	49.9	31.0					40.3								
RE-KK6P-16L	ø16	21.0	26.5	53.5								34.0	25.0	13.0	—	58.7	48.7		

**快换接头面板安装型**

(mm)



主体尺寸	型号	适合管子外径	T 螺纹	H1 六角对边	H2 六角对边	L <sub>1</sub>	L <sub>2</sub>	L <sub>3</sub>	M	最小孔径	有效截面积 mm <sup>2</sup>		质量 g							
											聚氨酯管	尼龙管								
M5	RE-KK2P-23E	ø3.2	M8×0.75	10	10	28.3	12.3	12.5	12.7	2.5			6.0							
	RE-KK2P-04E	ø4	M9×0.75	12																
	RE-KK2P-06E	ø6	M11×0.75	14	28.6									12.7	13.5	3.4	8.1	8.1	9.7	
1/8	RE-KK3P-04E	ø4	M12×1	17	17	39.3	18.4						16.6							
	RE-KK3P-06E	ø6	M14×1											40.2	16.8	17.0	4.7	10.1	12.8	22.3
	RE-KK3P-08E	ø8	M16×1											43.4	20.0	18.5	6.0	15.7	22.6	30.2
	RE-KK3P-10E	ø10	M20×1											46.4	22.0	21.0		22.6		54.7
1/4	RE-KK4P-06E	ø6	M14×1	17	17	47.0	25.2						30.6							
	RE-KK4P-08E	ø8	M16×1	19	19									50.2	20.0	18.5	6.2	19.8	22.6	38.2
	RE-KK4P-10E	ø10	M20×1	22	24									53.2	22.0	21.0	7.7	27.6	35.3	61.4
	RE-KK4P-12E	ø12	M22×1	24	27									54.2	23.0	22.0	9.0	40.2	50.9	75.2
1/2	RE-KK6P-12E	ø16	M28×1.5	30	32	62.6	31.0						86.1							
RE-KK6P-16E	ø16	M28×1.5	30	32	62.6									24.5	25.0	13.0	—	106.2	125.0	

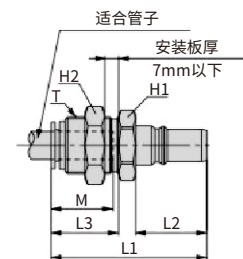



**外形尺寸图/插座(S)**
**外螺纹式**

(mm)

RE-KK2



RE-KK3·4·6



器体尺寸	型号	T接管口径	H六角对边	øD	L <sub>1</sub>	L2连接时	※A <sub>1</sub>	※A <sub>2</sub> 连接时	最小孔径	有效截面积mm <sup>2</sup>	质量g		
M5	RE-KK2S-M5M	M5×0.8	8	10.4	24.7	26.2		23.7	2.5	3.8	6.1		
	RE-KK2S-01MS	R1/8	10		25.3	26.8		22.8	4.7	5.8	9.1		
1/8	RE-KK3S-01MS	R1/8	14	20.2	37.5	40.0	33.5	36.0	6.0	20.4	20.1		
	RE-KK3S-02MS	R1/4			41.9	44.4	31.5	34.0	9.0	21.1	19.2		
1/4	RE-KK3S-03MS	R3/8	17	28.0	38.7	41.2	32.2	34.5	9.0	21.1	29.0		
	RE-KK4S-01MS	R1/8	50.4		54.1	46.4	50.1	6.0				22.9	47.5
	RE-KK4S-02MS	R1/4	51.0		54.7	45.0	48.7	9.0				38.9	44.1
	RE-KK4S-03MS	R3/8	50.0		53.7	43.5	47.2	11.0				40.4	50.9
1/2	RE-KK4S-04MS	R1/2	22	31.6	49.7	53.4	41.7	45.4	13.0	42.7	61.2		
	RE-KK6S-03MS	R3/2			53.7	59.0	11.0	71.7	87.9				
	RE-KK6S-04MS	R1/2			52.2	57.5	13.0	82.3	90.1				
	RE-KK6S-06MS	R3/4	27		50.7	56.0	15.0	83.8	113.3				

※R螺纹拧入后的参考尺寸。

RE-KK2

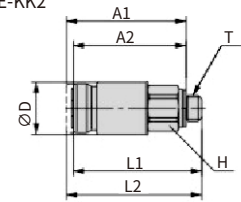

RE-KK3·4·6

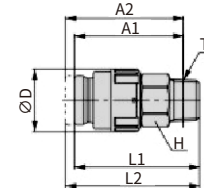
**内螺纹式**

(mm)

RE-KK2



RE-KK3·4·6



器体尺寸	型号	T接管口径	H六角对边	øD	L <sub>1</sub>	L2连接时	最小孔径	有效截面积mm <sup>2</sup>	质量g
M5	RE-KK2S-M5F	M5×0.8	8	10.4	25.3	26.8	4.2	5.4	6.4
	RE-KK3S-01F	Rc1/8	14		36.0	38.5		20.6	23.6
1/8	RE-KK2S-02F	Rc1/4	17	20.2	40.1	42.6	8.2	21.1	34.4
	RE-KK3S-03F	Rc3/8			41.9	44.4		21.1	38.8
1/4	RE-KK4S-02F	Rc1/8	19	28.0	50.4	54.1	10.9	39.6	56.9
	RE-KK4S-03F	Rc3/8			51.1	54.8	14.4	42.7	46.2
1/2	RE-KK6S-03F	Rc3/8	24	31.6	58.6	63.9		83.1	93.6
	RE-KK6S-04F	Rc1/2			61.0	66.3	18.0	83.8	87.4

RE-KK2

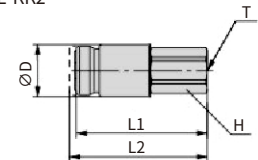

RE-KK3·4·6

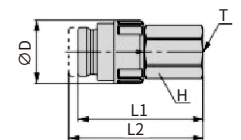
**带螺母管接头式(夹布聚氨酯软管用)**

(mm)



器体尺寸	型号	T接管口径	H1六角对边	H2六角对边	øD	L <sub>1</sub>	L2连接时	M	最小孔径	有效截面积mm <sup>2</sup>	质量g
1/8	RE-KK3S-50N	5/8	14	14	20.2	42.6	45.1	13.7	4.5	12.2	32.1
	RE-KK3S-60N	6/9	17	17		44.4	46.9	16.5	5.4	18.3	48.7
	RE-KK3S-65N	6.5/10				44.4	46.9	16.5	5.9	19.2	46.4
1/4	RE-KK4S-50N	5/8	19	17	28.0	54.1	57.8	13.7	4.5	12.2	55.8
	RE-KK4S-60N	6/9				46.8	60.5	16.5	5.4	20.4	69.3
	RE-KK4S-65N	6.5/10				5.9	24.1	66.8			
	RE-KK4S-80N	8/12				7.4	35.1	68.5			
1/2	RE-KK4S-85N	8.5/12.5	24	19	31.6	55.4	59.1		7.4	36.6	71.1
	RE-KK6S-80N	8/12				17.4	7.4	36.6	107.5		
	RE-KK6S-85N	8/12.5				7.8	41.2	110.2			
	RE-KK6S-10N	11/16				20.1	10.2	68.4	119.8		

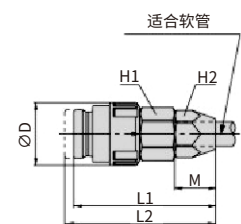



**直通型带快换接头**

(mm)

主体尺寸	型号	适合管子外径	øD <sub>1</sub>	øD <sub>2</sub>	L <sub>1</sub>	L <sub>2</sub> 连接时	M	最小孔径	有效截面积 mm <sup>2</sup>		质量 g	
									聚氨酯管	尼龙管		
M5	RE-KK2S-23H	ø3.2	10.4	7.0	33.8	35.3	12.7	2.5	3.8	4.6	6.4	
	RE-KK2S-04H	ø4		8.0	33.6	35.4		3.4	4.0	4.8	6.5	
	RE-KK2S-06H	ø6		10.0	34.5	36.4		4.7	5.8	5.8	7.9	
1/8	RE-KK3S-04H	ø4	20.2	10.0	46.6	49.1	17.0	3.2	3.8	5.8	22.5	
	RE-KK3S-06H	ø6		12.0	47.1	49.6		4.7	10.4	13.4	24.4	
	RE-KK3S-08H	ø8		14.0	48.9	51.4		18.5	6.2	16.8	18.9	27.3
1/4	RE-KK3S-10H	ø10	28.0	17.0	49.9	52.4	21.0	7.7	19.1	19.1	37.1	
	RE-KK4S-06H	ø6		12.0	58.2	61.9		17.0	4.7	10.4	13.4	51.4
	RE-KK4S-08H	ø8		14.0	60.1	63.8		18.5	6.2	18.3	21.8	51.3
1/2	RE-KK4S-10H	ø10	31.6	17.0	61.5	65.2	21.0	7.7	27.0	29.4	54.8	
	RE-KK4S-12H	ø12		19.0	62.5	66.2		22.0	9.2	30.5	32.0	59.4
	REKK6S-12H	ø12		70.1	75.4	22.0		13.2	42.7	48.8	84.1	
	RE-KK6S-16H	ø16		25.7	72.3	77.6	25.0		53.4	62.5	99.9	

RE-KK2



RE-KK3·4·6



RE-KK2

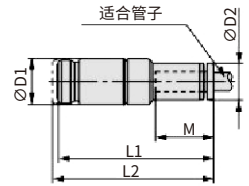

RE-KK3·4·6

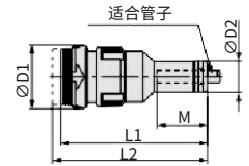
**弯头型带快换接头**

(mm)

主体尺寸	型号	适合管子外径	øD <sub>1</sub>	øD <sub>2</sub>	L <sub>1</sub>	L <sub>2</sub> 连接时	L <sub>3</sub>	M	最小孔径	有效截面积 mm <sup>2</sup>		质量 g		
										聚氨酯管	尼龙管			
M5	RE-KK2S-23L	ø3.2	10.4	9.3	26.0	27.5	16.5	12.7	2.5	3.7	4.4	6.7		
	RE-KK2S-04L	ø4		11.6	27.2	28.3	16.6	13.5	4.5	5.6	5.6	7.2		
	RE-KK2S-06L	ø6		10.4	41.7	44.2	18.0	16.0	3.0	3.7	5.3	23.2		
1/8	RE-KK3S-04L	ø4	20.2	12.8	42.9	45.4	20.0	17.0	4.5	10.11	11.4	24.0		
	RE-KK3S-06L	ø6		15.2	43.1	45.6	23.0	18.5	6.0	15.0	16.8	25.0		
	RE-KK3S-08L	ø8		18.5	42.9	45.4	26.5	21.0	7.5	18.0	18.5	34.4		
1/4	RE-KK3S-10L	ø10	28.0	12.8	54.3	58.0	20.0	17.0	4.5	10.1	11.4	53.5		
	RE-KK4S-06L	ø6		15.2	55.5	59.2	23.0	18.5	6.0	17.5	19.8	53.0		
	RE-KK4S-08L	ø8		18.5	54.2	57.9	26.5	21.0	7.5	24.7	27.5	54.7		
1/2	RE-KK4S-10L	ø10	31.6		55.4	59.1	28.5	22.0	9.0	29.0	29.6	57.0		
	RE-KK4S-12L	ø12		66.3	71.6	38.1							39.7	91.4
	RE-KK6S-12L	ø12		26.5	66.9									

RE-KK2



RE-KK3·4·6



RE-KK2

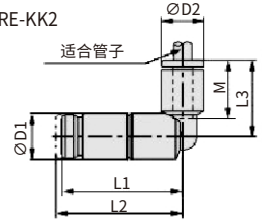

RE-KK3·4·6

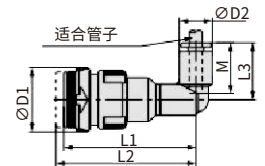
**面板安装型带快换接头**

(mm)

主体尺寸	型号	适合管子外径	T 螺纹	H1 六角对边	H2 六角对边	øD	L <sub>1</sub>	L <sub>2</sub> 连接时	L <sub>3</sub>	M	最小孔径	有效截面积 mm <sup>2</sup>		质量 g					
												聚氨酯管	尼龙管						
M5	RE-KK2S-23E	ø3.2	M8×0.75	10	10	10.4	34.5	35.3	13.0	12.7	2.5	3.8	4.6	9.6					
	RE-KK2S-04E	ø4	M9×0.75	10	12		34.2	35.4			4.7	5.8	5.8	12.6					
	RE-KK2S-06E	ø6	M11×0.75	14	14		46.6	49.1			16.9	16.0	3.2	3.8	5.8	29.0			
1/8	RE-KK3S-04E	ø4	M12×1	14	17	20.2	47.1	49.6	17.0	17.0	4.7	10.4	13.4	39.4					
	RE-KK3S-06E	ø6	M14×1	17	19		49.0	51.5			20.0	18.5	6.2	16.8	18.9	43.4			
	RE-KK3S-08E	ø8	M16×1	19	19		49.9	52.4			22.0	21.0	7.7	19.1	19.1	68.3			
1/4	RE-KK3S-10E	ø10	M20×1	22	24	28.0	58.2	61.9	17.0	17.0	4.7	10.4	13.4	57.2					
	RE-KK4S-06E	ø6	M14×1	19	19		60.1	63.8			20.0	18.5	6.2	18.3	21.8	60.6			
	RE-KK4S-08E	ø8	M16×1	19	19		61.7	65.4			22.0	21.0	7.7	27.0	29.4	86.8			
1/2	RE-KK4S-10E	ø10	M20×1	22	21	31.6	62.7	66.4	23.0	22.0	9.2	30.5	32.0	105.7					
	RE-KK4S-12E	ø12	M22×1	24	27		70.1	75.4							24.5	25.0	42.7	48.8	116.0
	RE-KK6S-12E	ø12	M22×1	24	27		72.5	77.8											

RE-KK2



RE-KK3·4·6



RE-KK2

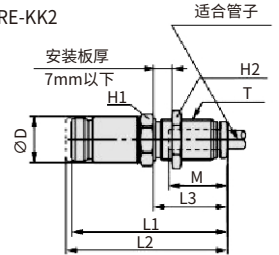

RE-KK3·4·6

